

## Twin Stud - Acoustic (CWS-4SS)

### Description

Frame : JayaBMS Wall Track, JayaBMS C Stud, JayaBMS Furring

Lining : 1 layer of Jayaboard Soundstop 12mm (both sides)  
+ 1 layer of USG Boral Jayabell 12mm (1 side)

Weight : ± 28.5 kg/m<sup>2</sup>

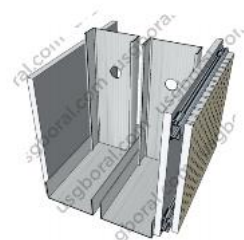

STUD SIZE (mm)		MAXIMUM HEIGHT (mm) Non-Load Bearing Studs			WALL THICKNESS (mm)	FIRE RATING (minutes)	ACOUSTIC RATING (STC)	
Width	Thickness	@600mm centres	@400mm centres	Grade BS 5234			Without Insulation	Insulation Mineral Wool 50mm
51	0.4	2750	3150	Heavy Duty	183	Non FRL	42	55
	0.5	2950	3400			30		
64	0.4	3250	3800		209	Non FRL	43	56
	0.5	3550	4200			30		
	0.7	4100	5000			30		
76	0.4	3800	4600		233	Non FRL	44	58
	0.5	4200	5150			30		
	0.7	4950	5900			30		
92	0.5	5250	6100		265	30	45	58
	0.7	5950	6800			30		
100	0.5	5700	6500	281	30	45	58	
	0.7	6350	7250		30			
150	0.7	8750	9950	381	30	47	58	